



A SERENE SANCTUARY

IN SEYCHELLES

Immerse yourself in the **epitome of luxury** at **Waldorf Astoria Seychelles Platte Island**, where spacious accommodation, unique experiences and unparalleled service harmoniously blend with the **islands lush tropical surroundings**. From curated experiences and fine dining to iconic Waldorf Astoria Spa and vibrant wildlife, Platte Island **promises an unforgettable escape for all**.

From our **thoughtful villa architecture** to the use of locally sourced, seasonal ingredients in our restaurants, every detail reflects our **commitment to sustainable luxury** and a respect for the island's natural ecosystem.

50 private pool villas | 6 food and drink venues
| Villas with direct access to the beach and featuring expansive gardens | From one to five bedroom villas for multi-generational experiences | World-class spa and wellness facilities | A wide range of watersports and activities | Kids facilities | Personal concierge

RESTAURANTS AND BARS

Explore our collection of **six restaurants and bars**. At Moulin, embark on an exclusive soil-to-soul journey where, seasonal, freshly harvested ingredients are transformed into a **refined culinary experience**. Immerse yourself in the vibrant flavors and traditions of Creole and Latino cuisine at Maison des Epices. For a more **relaxed ambiance**, enjoy Northern Mediterranean classics with an Asian twist at La Perle.

Unwind by the pool at Torti, offering Asian-inspired dishes, or opt for a more **private experience** with one of our in-villa dining menus.

SPA AND WELLNESS

Inspired by the natural **beauty of Platte Island**, our spa and salon offer personalized wellness experiences, crafted with eco-conscious practices. Explore a range of **traditional and modern treatments**, indoor and outdoor facilities, and tailored wellness programs that provide deeper insights into your well-being, along with customized recommendations for your **future wellness journey**.

EXPERIENCES



Welcome to a world of **indulgence and adventure** where opulence meets exploration.

Fishing | Snorkeling | Ocean cruises | Food and drink masterclasses | Private dining | Outdoor cinema | Tennis and padel | Wildlife walks



HAWKSBILL GARDEN POOL VILLA

ONE BEDROOM VILLA

-  SLEEPS TWO + ONE EXTRA BED
-  141 SQ M | 1518 SQ FT

This beautifully designed villa features a **spacious bedroom with a king-sized bed**, separate living room and luxurious bathroom for ultimate comfort. Step outside to your **private deck**, complete with an outdoor dining area and a **private pool**.

The villa also boasts a **lush private garden** and an **invigorating outdoor shower** for a true natural escape.

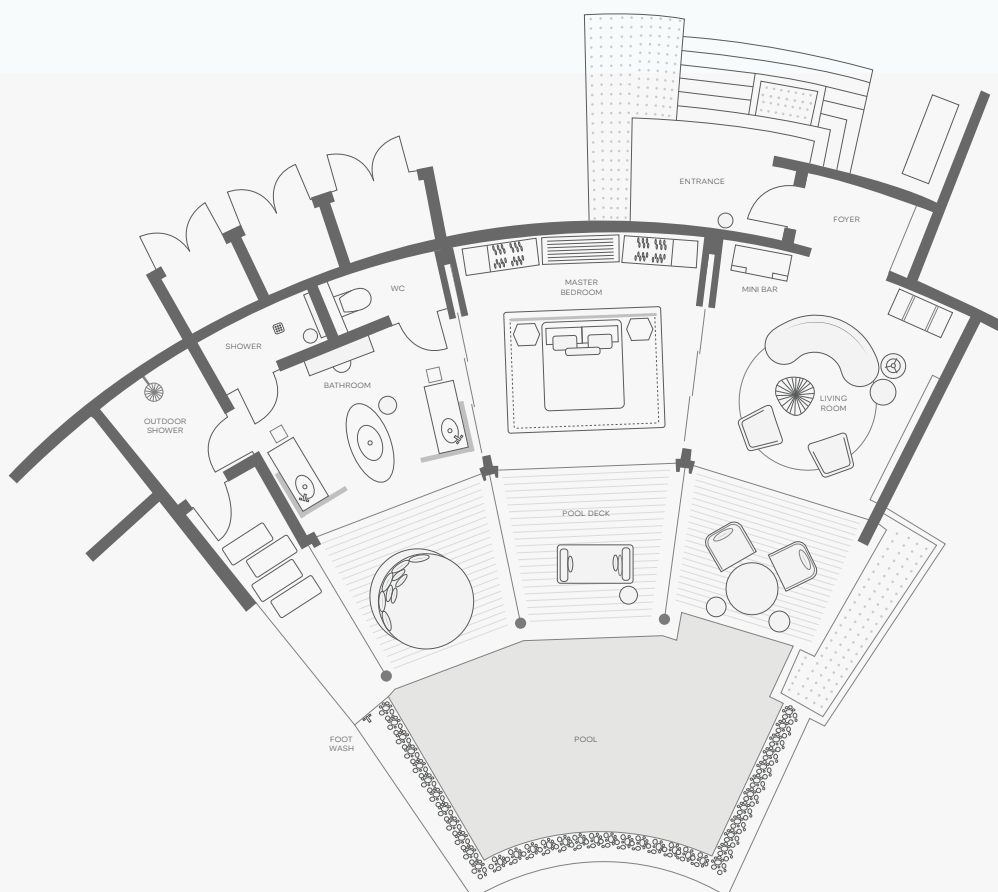



HAWKSBILL POOL VILLA

ONE BEDROOM VILLA

 SLEEPS TWO + ONE EXTRA BED

 141 SQ M | 1518 SQ FT

Relax in this thoughtfully designed villa, which features **one bedroom** with a **king-sized bed**, separate living room and **luxurious bathroom**.

Enjoy outdoor living, as the villa opens onto a **spacious deck** with its own **private pool** and outdoor dining space. Revel in **direct beachfront access** and invigorate your senses with an outdoor shower.

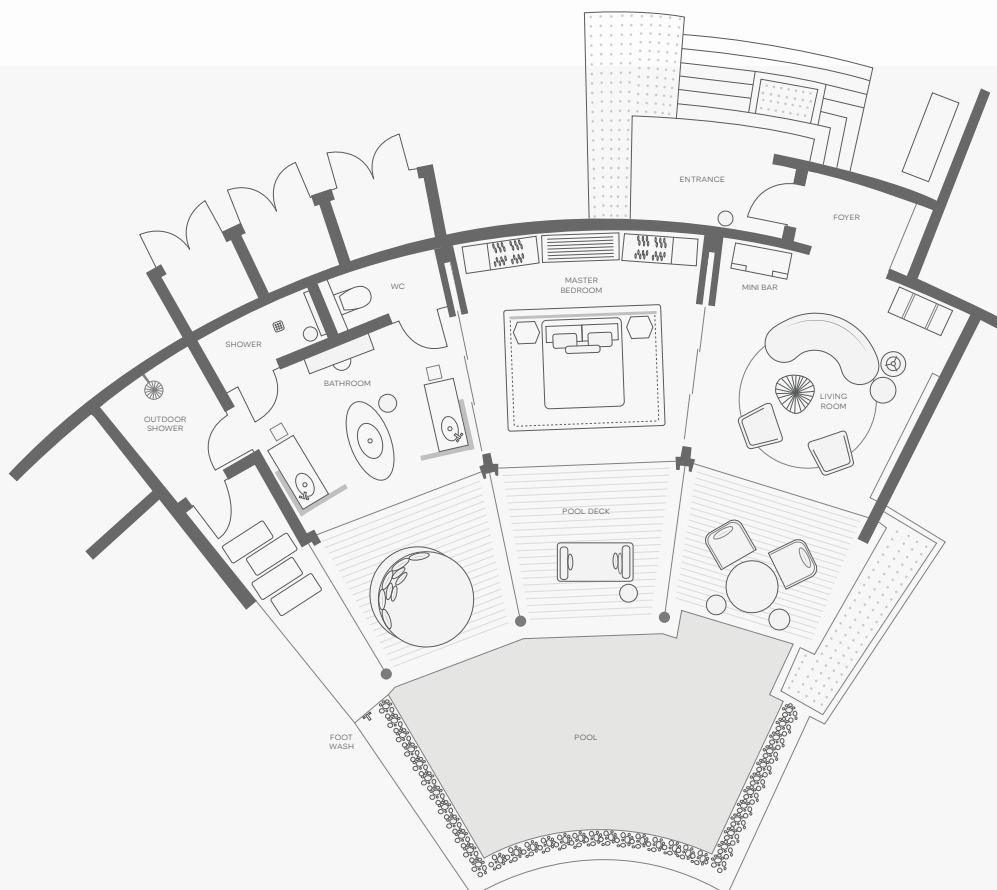

 DISCOVER THIS
VILLA IN 3D



GRAND HAWKSBILL POOL VILLA

ONE BEDROOM VILLA WITH A STUDY ROOM

 SLEEPS FOUR

 194 SQ M | 2088 SQ FT

Drawing on our heritage of **timeless elegance** with a modern sensibility our villas are designed to be a **sanctuary of elegance** and comfort.

Featuring a bedroom with one **king-sized bed**, elegant master bathroom and separate living room, the Grand Hawksbill Villa also offers the flexibility of an extra bedroom or study space with en-suite shower room. It also includes, **outdoor deck with dining space**, outdoor shower, private pool and garden with **direct beach access**.

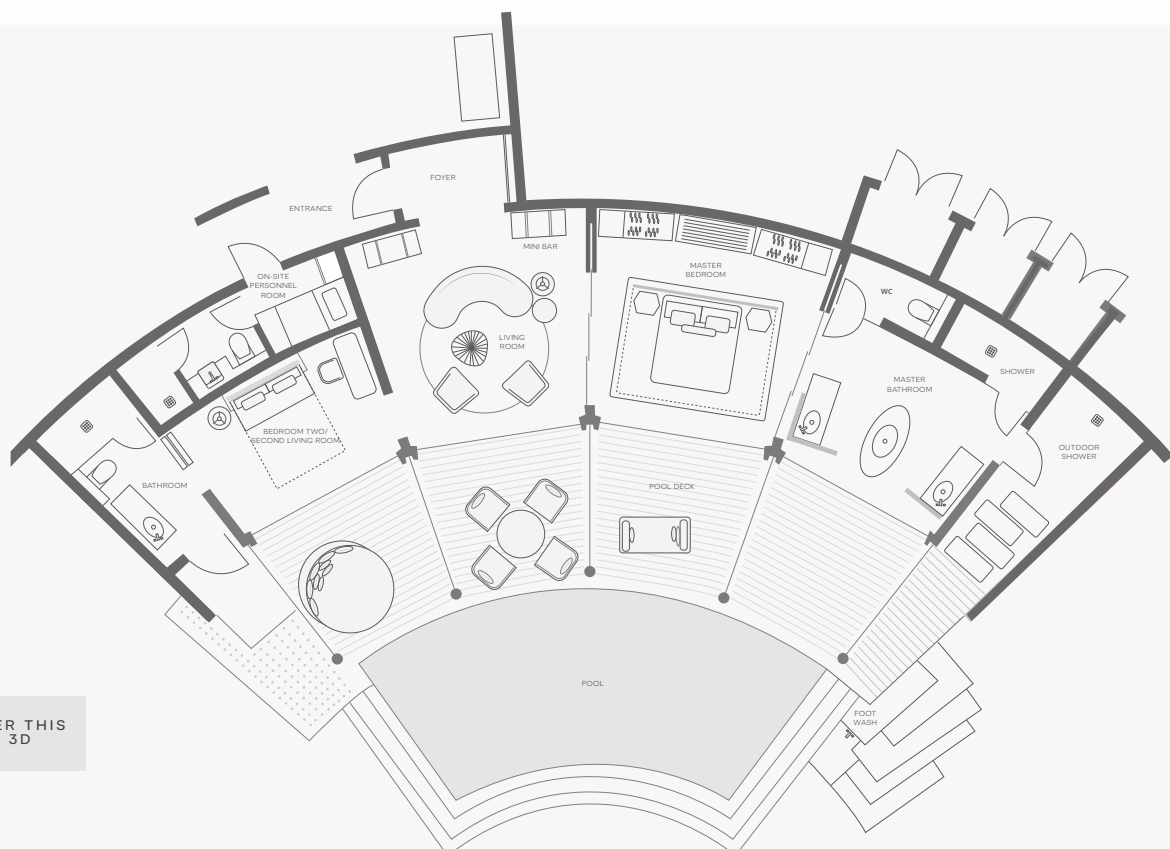

 DISCOVER THIS VILLA IN 3D



BLACKTIP POOL VILLA

TWO BEDROOM VILLA



SLEEPS FOUR



393 SQ M | 4231 SQ FT

Enjoy the charm of this **spacious villa**, which features **two bedrooms**, one with a **king-sized bed** and the other with **two queen beds**. Each bedroom boasts a spacious bathroom with a bathtub and walk-in shower. This villa also benefits from a **generous outdoor terrace** with its own private pool and outdoor dining space.

Enjoy **direct access to the beach** and outdoor shower to help you cool off. The indoor space features a separate living room. A nanny room with en-suite is also available.

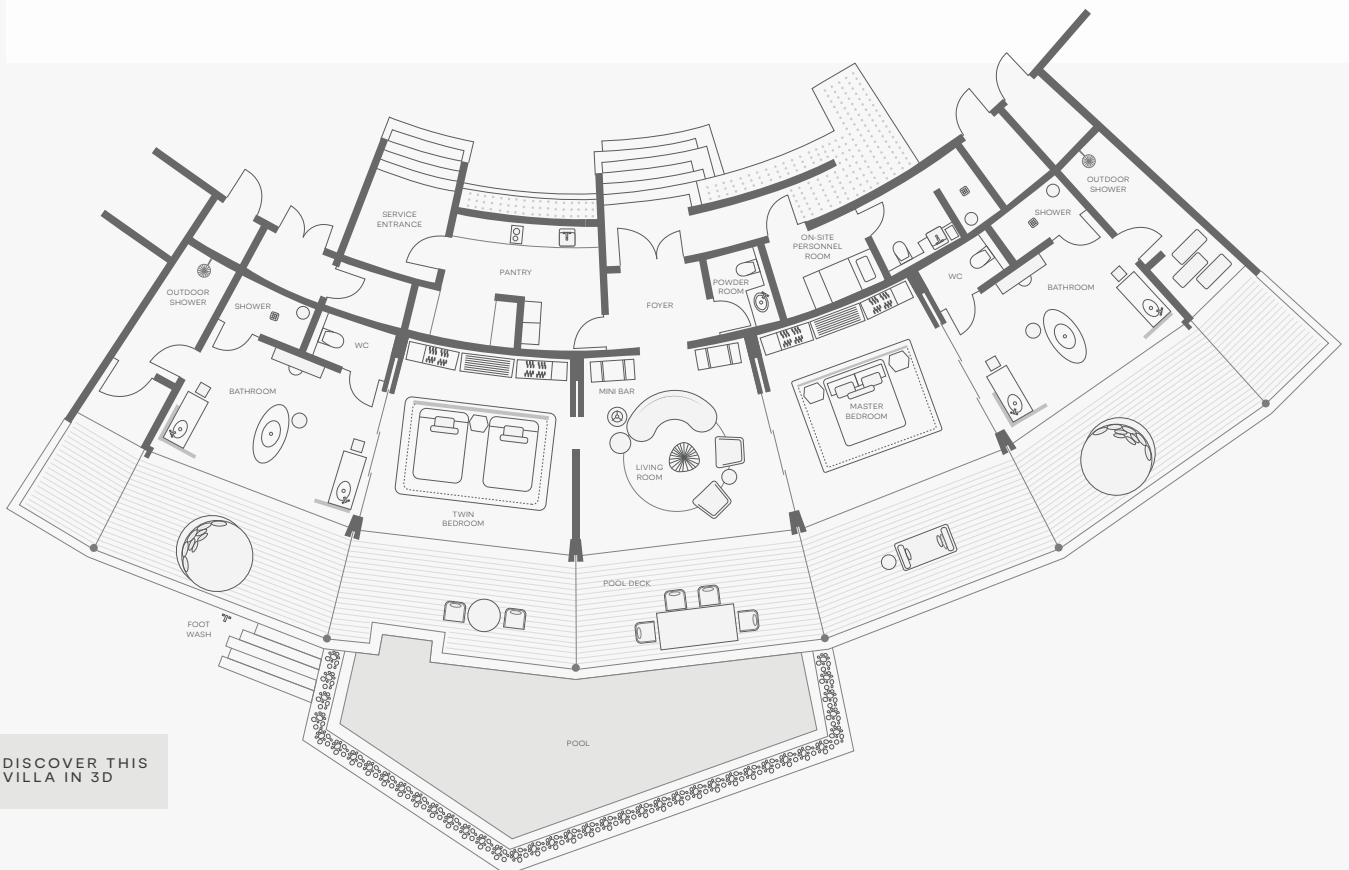

DISCOVER THIS
VILLA IN 3D



KINGFISH POOL VILLA

THREE BEDROOM VILLA

 SLEEPS SIX

 472 SQ M | 5080 SQ FT

This **spacious villa** offers flexible options for a family stay. Enjoy either **three king bedrooms** or **two king bedrooms** and one queen twin room. Each bedroom with its own bathroom. The indoor space also benefits from a separate living room, powder room for guests and separate nanny room with en-suite.

Enjoy a **spacious outdoor terrace** with outdoor dining space, private pool and tropical garden with **direct beach access**.

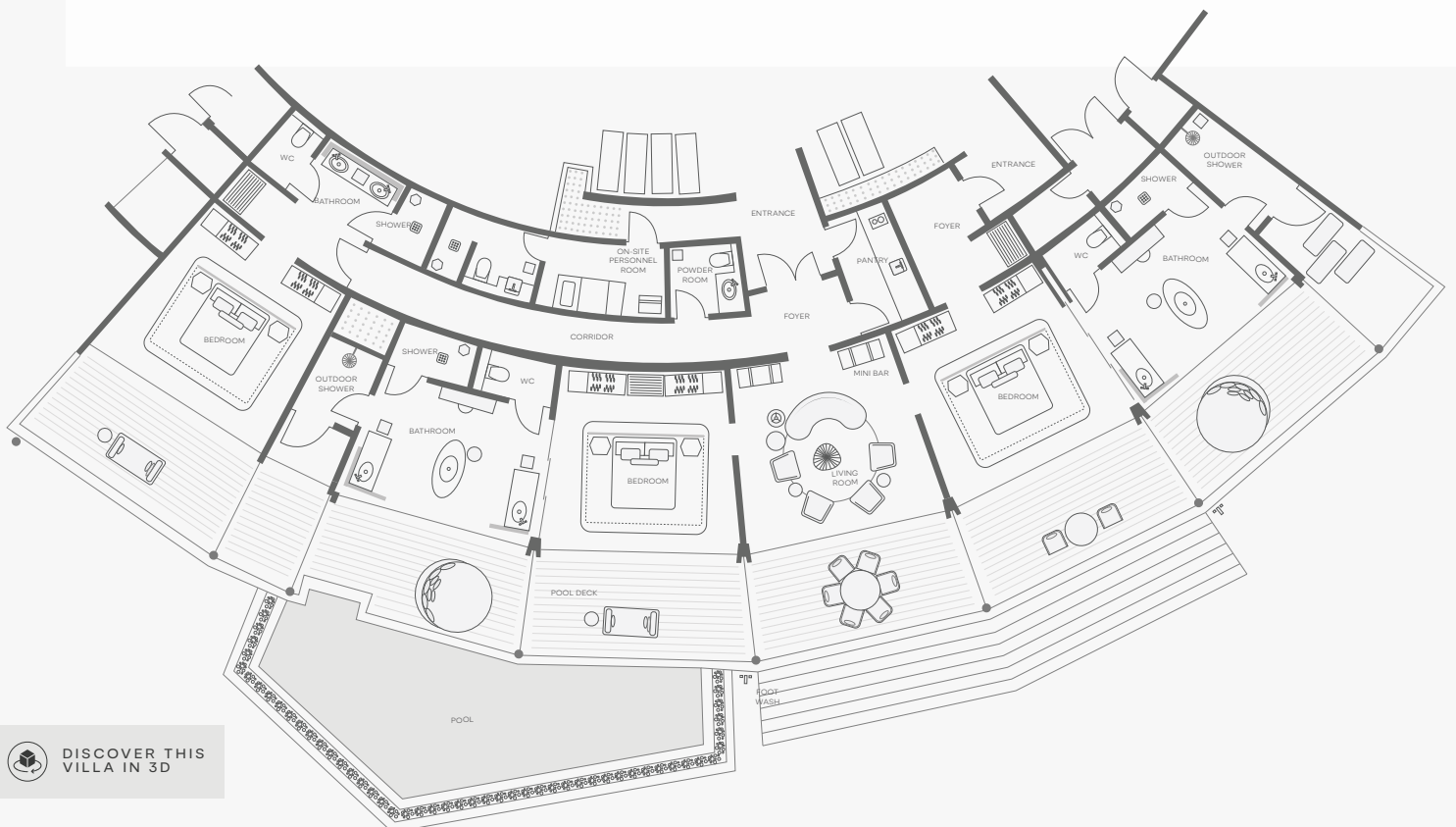

 DISCOVER THIS
VILLA IN 3D



EAGLE RAY POOL VILLA

FIVE BEDROOM VILLA

 SLEEPS TEN

 751 SQ M | 8084 SQ FT

Enjoy the flexibility of this elegant suite, which is ideally situated in a secluded enclave. With **5 separate bedrooms**, each with one **king-sized bed and en-suite bathroom**.

Relax in the **separate living room**, complete with its own state-of-the-art entertainment system and a powder room for guests. The master suite also features its **own private pool**. The villa further benefits from a nanny room with an en-suite bathroom, as well as a service kitchen. An exclusive suite, this villa provides **both space and privacy for the entire family**.

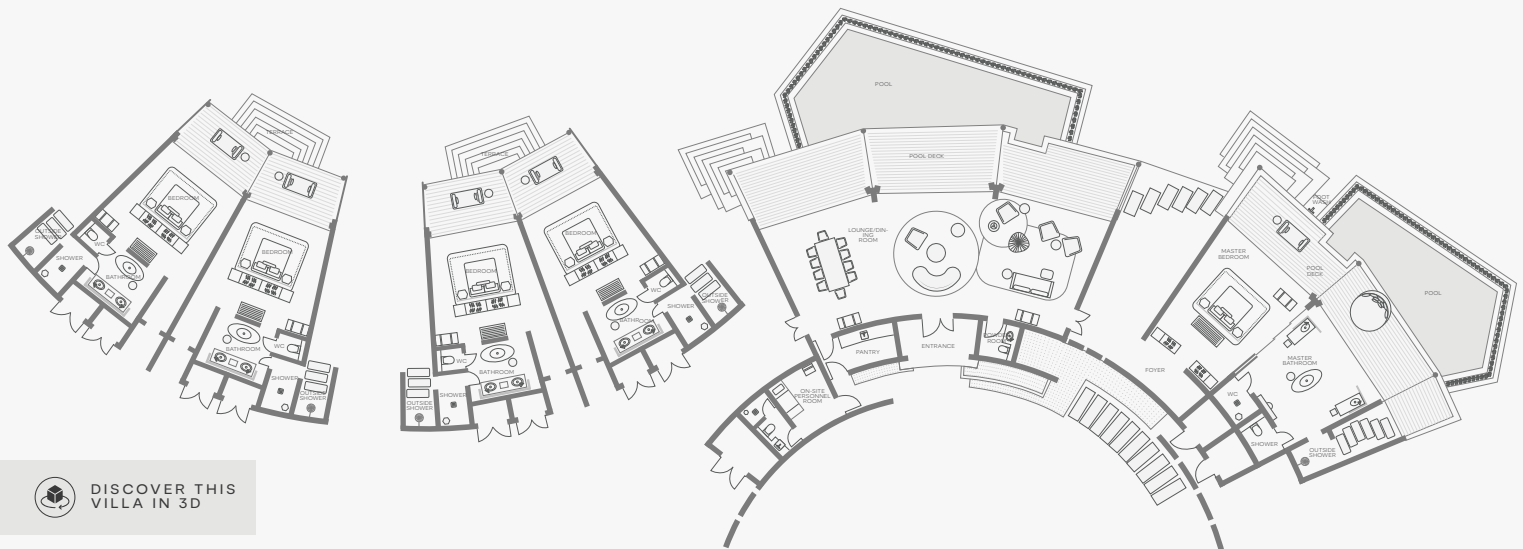

 DISCOVER THIS VILLA IN 3D



MOULIN

SOIL-TO-SOUL

Moulin offers a **soil-to-soul dining experience**, rooted in the philosophy of transforming nature's bounty into a **journey of sustainability** and flavor that also nourishes wellbeing.

The experience begins with seasonal, **locally sourced ingredients**—many freshly harvested from the restaurant's own garden—and crafted into **exclusive menus** that celebrate both the environment and culinary excellence. Each dish is paired with fine wines or teas, **carefully chosen to enhance the natural flavors**. Exclusive to Moulin, also renowned for its award-winning architecture and captivating atmosphere, the Soil to Soul concept creates a holistic, immersive dining experience that **engages all the senses**.

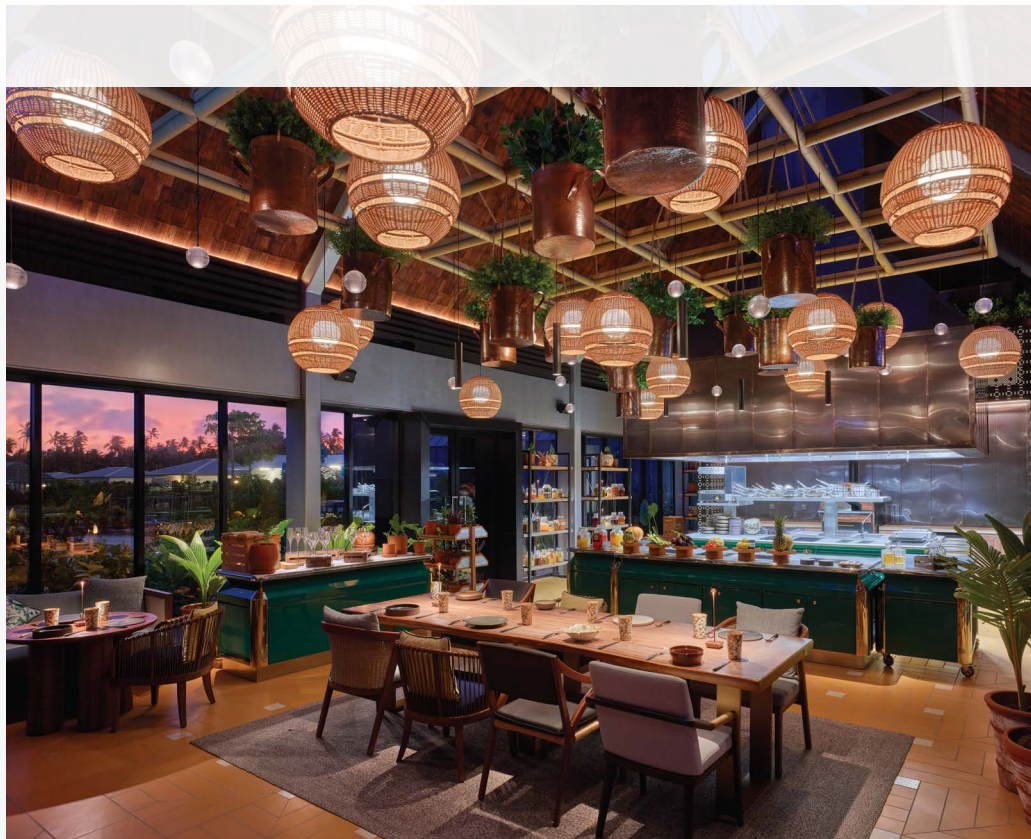



MAISON DES EPICES

CREOLE-LATIN
FUSION

Maison des Epices is a restaurant that **blends Creole and Latino cultures**, celebrating their rich traditions, flavors, and heritage. With an emphasis on authenticity, the restaurant features **open-fire cooking** using sustainable wood, creating a unique and flavorful dining experience.

Handmade spices elevate each dish, while the extensive, curated, liquor collection, unique to Creole and Latino traditions, complements the flavors. The **vibrant atmosphere** is enhanced by music, adding to the ambiance and offering guests a **true taste of cultural fusion**.





LA PERLE

MEDITERRANEAN
BRASSERIE

La Perle is a **vibrant brasserie** inspired by **Northern Mediterranean and Asian cuisines**. By day, it offers a personalized, wholesome breakfast featuring freshly baked artisanal items, a variety of hot and cold dishes, and expertly brewed Tanzanian coffee. At lunch, the restaurant creates a **relaxed atmosphere** with Northern Mediterranean classics, subtly enhanced by Asian influences.

As evening falls, La Perle **celebrates the ocean's bounty** with locally sourced seafood and the freshest daily catch, expertly paired with the rich flavors of the Northern Mediterranean and **inventive global twists**, offering a laid-back yet unforgettable dining experience.





LALIN

CHAMPAGNE BAR

Lalin, named after the **Creole term for the moon**, is a champagne bar with breathtaking views of the ocean. Savor **delightful sunsets** while enjoying your favorite drinks.

Evening stars set the stage for **elegant pre-dinner indulgence** and refined nocturnal sips at Lalin. The vibrant venue showcases an array of inventive **cocktails crafted with artistic flair**.



TORTI

BEACH BAR

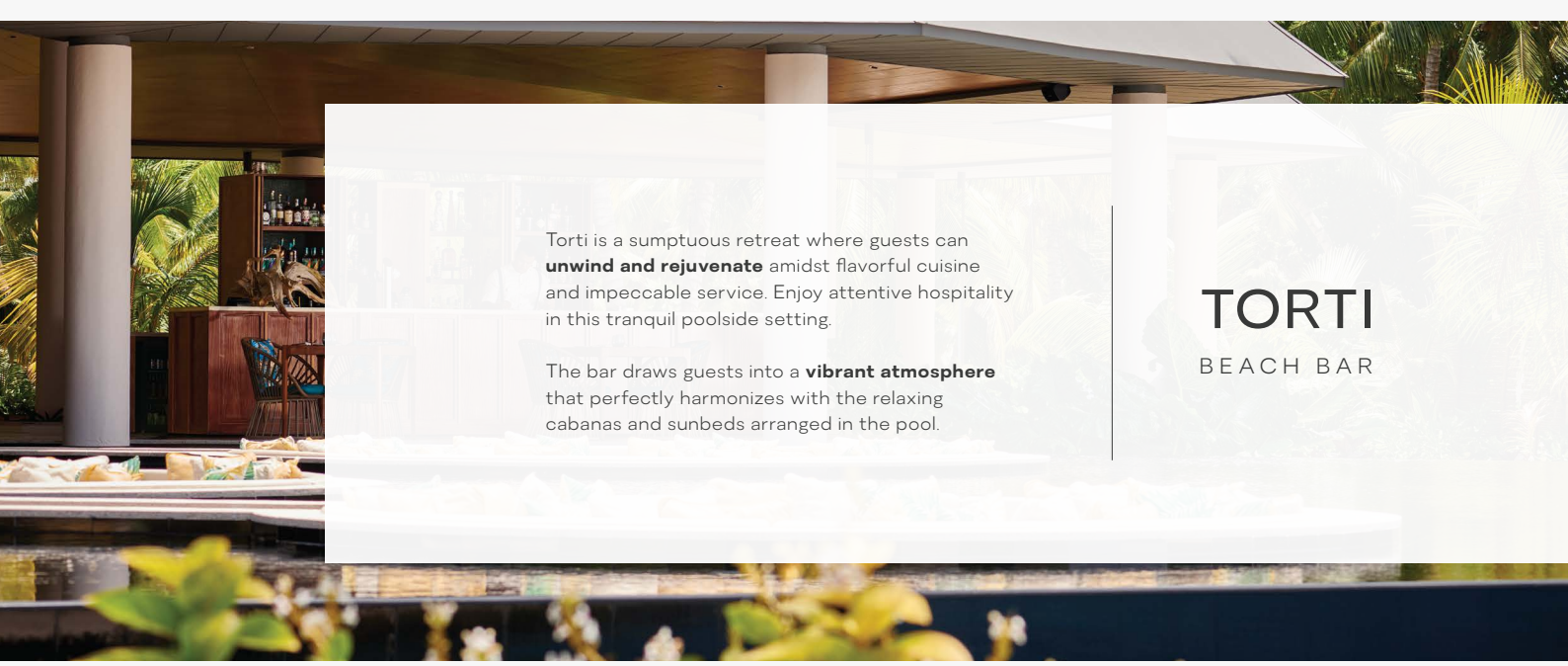

Torti is a sumptuous retreat where guests can **unwind and rejuvenate** amidst flavorful cuisine and impeccable service. Enjoy attentive hospitality in this tranquil poolside setting.

The bar draws guests into a **vibrant atmosphere** that perfectly harmonizes with the relaxing cabanas and sunbeds arranged in the pool.



PEACOCK TERRACE

PARISIAN INSPIRED

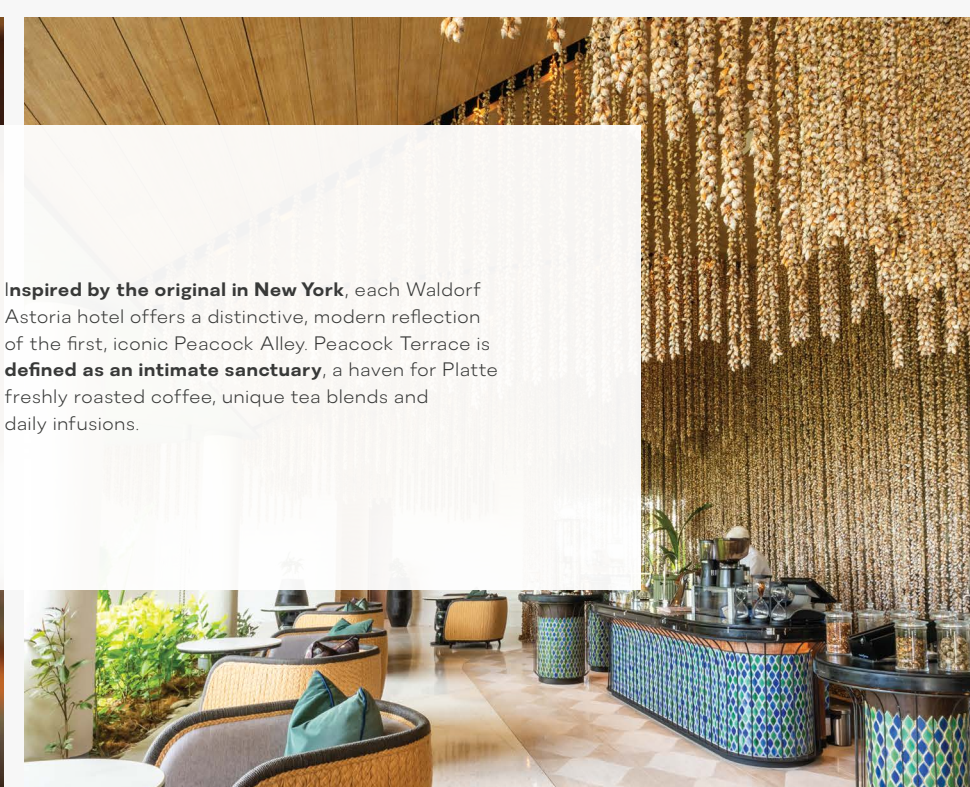

Inspired by the original in New York, each Waldorf Astoria hotel offers a distinctive, modern reflection of the first, iconic Peacock Alley. Peacock Terrace is **defined as an intimate sanctuary**, a haven for Platte freshly roasted coffee, unique tea blends and daily infusions.



WALDORF ASTORIA®
SEYCHELLES PLATTE ISLAND

**Contact us to craft an extraordinary
experience in paradise, tailored just for you.**

+248 439 7141 | SEZPI.HOTEL@WALDORFASTORIA.COM

STAY CONNECTED TO PARADISE – FOLLOW ALONG

@WALDORFASTORIAPLATTEISLAND